

REV  
B DT06-12S\*-EP20

REVISIONS			
SYM	DESCRIPTION	DATE	APPROVED
NC	NEW RELEASE PER E.O. P18803	2/28/05	R.D.R.
A	RELEASE PER E.O. P20698	12/23/10	R.D.R.
B	REVISED PER E.O. P20848	3-25-11	<i>ADL</i>

DATE CODE: MONTH REPRESENTED  
BY SEQUENTIAL ALPHA CHARACTERS.  
EX. A = JANUARY

DATE CODE: YEAR IS REPRESENTED  
BY LAST NUMERICAL DIGIT.  
EX. 5 = 2005

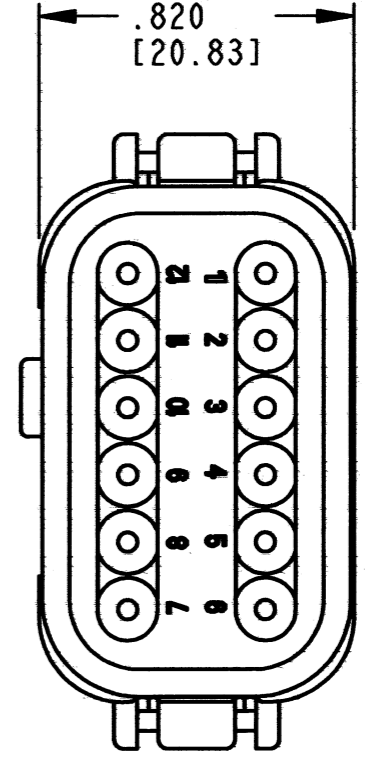
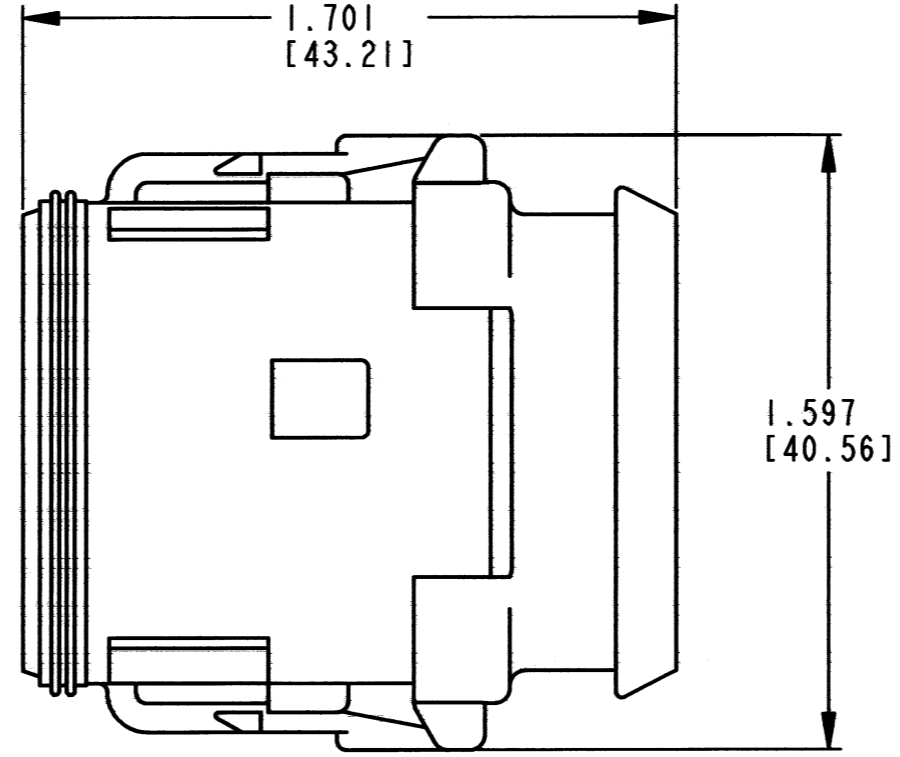
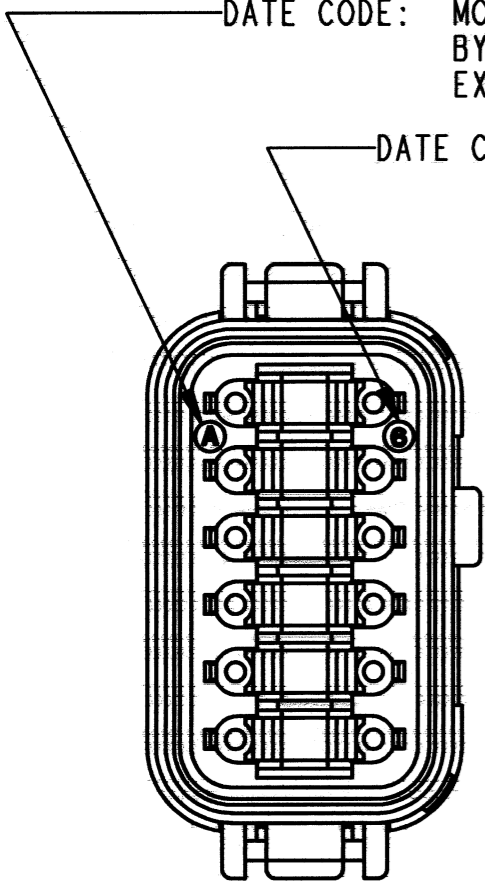

- 5. SHELL MATERIAL: PLASTIC;  
SEAL MATERIAL: RUBBER.
- 4. THIS PLUG MATES WITH DT04-12P\*-\*\*\*\* RECEPTACLE.  
(\*\*\*\* = ALL MODIFICATIONS). CONSULT FACTORY FOR ALL MODIFICATIONS.
- 3. FOR CONTACTS AND WIRE PERFORMANCE AND APPLICATION CHARACTERISTICS,  
SEE ENVELOPE DRAWINGS 0425-015-0000 AND 0425-017-0000.
- 2. DIMENSIONS ARE ±.025[.64] UNLESS OTHERWISE SPECIFIED.

NOTES: 1. ALL DIMENSIONS ARE INCHES (MILLIMETERS).

CONTACT SIZE	MIN. INSUL O.D.	MAX. INSUL O.D.	WIRE RANGE [mm <sup>2</sup> ] REF. ONLY <sup>3</sup>
16	.088 [2.24]	.145 [3.68]	14-20 AWG [2.0-0.5]

SIGNATURE & DATE	
DR	X. SANCHEZ 03MAY04
CHK	<i>B. P. Ford</i> 3/23/2011
PE	<i>R. Messinger</i> 3/15/11
APPD	<i>S. Beard</i> 3/12/11
SCALE	NONE WT

12 WAY PLUG  
-EP20 MOD.  
D.T. SERIES

ENVELOPE

EP	MATL. CODE
3850 INDUSTRIAL AVE. HEMET, CA 92545	
<b>DEUTSCH INDUSTRIAL</b>	
<b>B</b>	<b>DT06-12S*-EP20</b>
DWG SIZE	CODE 11139 SHEET 1 OF 2

REV	DT06-12S*-EP20	REVISIONS			
B		SYM	DESCRIPTION	DATE	APPROVED
		B	SEE SHEET ONE	3-25-11	ADR

PART NO: DT06-12SA-EP20  
KEY ARR. -A-  
COLOR: GRAY

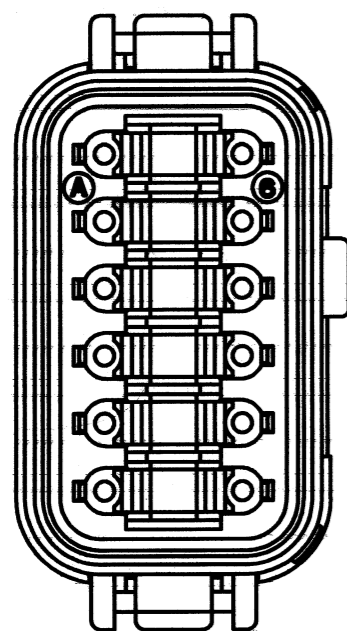

PART NO: DT06-12SB-EP20  
KEY ARR. -B-  
COLOR: BLACK

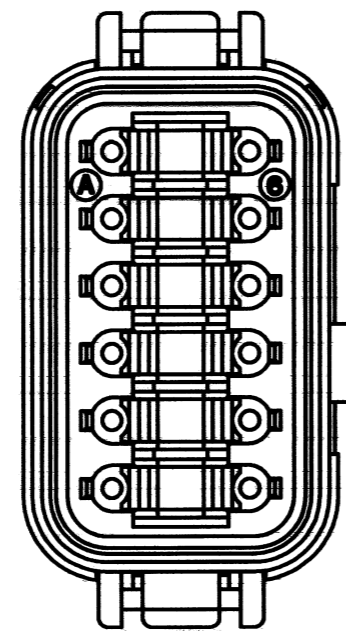

PART NO: DT06-12SC-EP20  
KEY ARR. -C-  
COLOR: GREEN

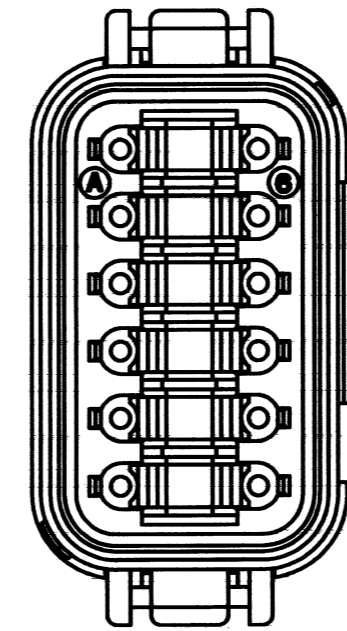

PART NO: DT06-12SD-EP20  
KEY ARR. -D-  
COLOR: BROWN

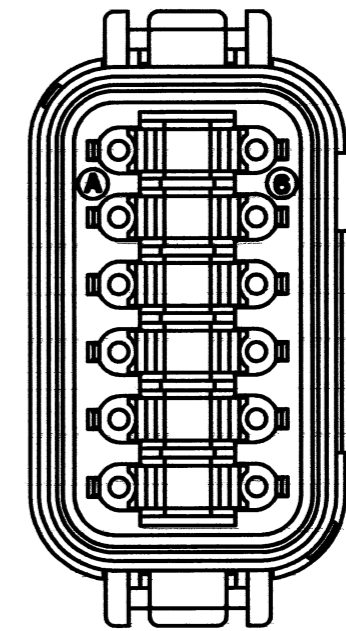

NOTES: SEE SHEET ONE

SIGNATURE & DATE		12 WAY PLUG -EP20 MOD. D.T. SERIES	EP	MATL. CODE
DR	X. SANCHEZ 03MAY04		3850 INDUSTRIAL AVE. HEMET, CA 92545	
CHK	<i>[Signature]</i> 3/23/2011		DEUTSCH INDUSTRIAL	
PE	<i>[Signature]</i> 3/15/11		B DT06-12S*-EP20	
APPD	<i>[Signature]</i> 3/18/14	ENVELOPE	DWG SIZE	CODE 11139
SCALE	NONE WT			